



### LX14HS Series Introduction

MOONS' LX14HS series (35mm compact) linear hybrid motor has large torque configuration with high thrust and long-life reliability. It offers innovative solutions for numerous linear motion applications.

configurations options :  
Noncaptive / External NUT

Range of Travel Per Step :  
0.00609 (0.00024") ~ 0.04876 (0.00192")



### ■ General Specifications

- Bi-polar

Type	LX14HS301XXX-XX
Rated Current	1.25A
Resistance Per Phase	2Ω
Inductance Per Phase	2.8mH
Temperature Rise	75°C
Weight	210g
Rotor Inertia	20g*cm <sup>2</sup>

\* Values truncated

ø6.35				
Lead		Travel Per Step		Order Code
in.	mm	in.	mm	
0.03125	0.79375	0.00015*	0.00396*	031
0.25	6.35	0.00125	0.03175	250



# KLS ELECTRONIC CO.,LTD

## Mechanical Dimension

Noncaptive LN14HS3

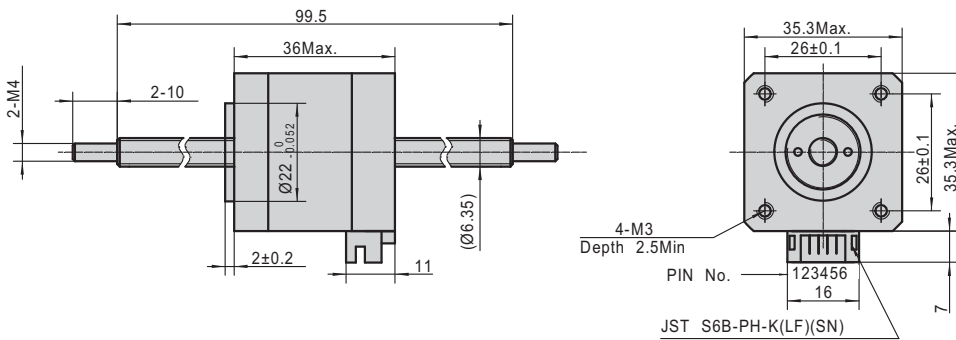

External NUT LE14HS3

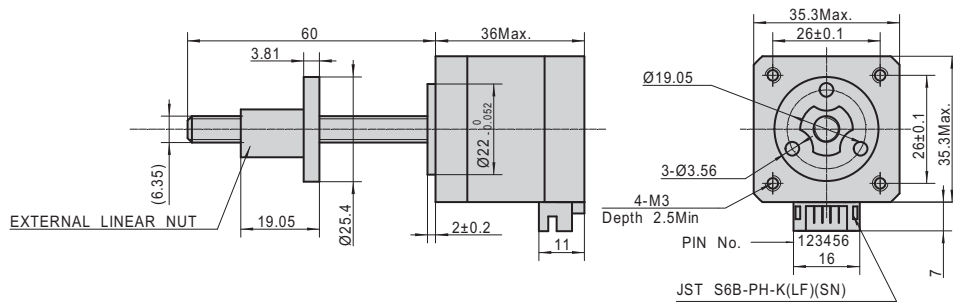

## Performance Curves

### LX14HS301XXX FORCE VS PULSE RATE

Conditions: Bi-polar Constant Current Driver  
 Driver: AMA MS3540M  
 Mode: Full Step

— 031 — 250 — 40V

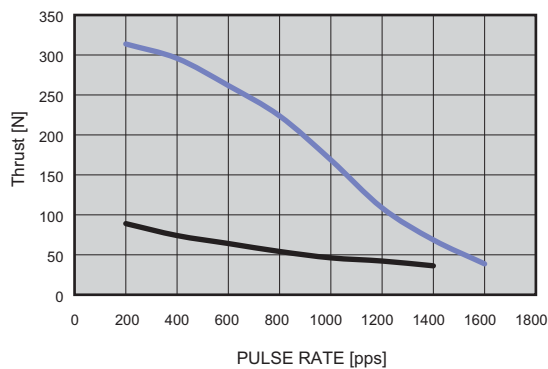

### LX14HS301XXX FORCE VS LINEAR VELOCITY

Conditions: Bi-polar Constant Current Driver  
 Driver: AMA MS3540M  
 Mode: Full Step

— 031 — 250

