

Material:  
Housing: 30% Glass filled PBT UL94V-0  
Contacts: Phosphor Bronze  
Plating: Tin plated 100u" over 50u" nickel

Electrical Characteristics:  
Current Rating: 1.0 AMP  
Insulator Resistance: 5000M Ohm min  
Contact Resistance: 20mΩmax.  
Operating Temperature: -40°C ~ +105°C

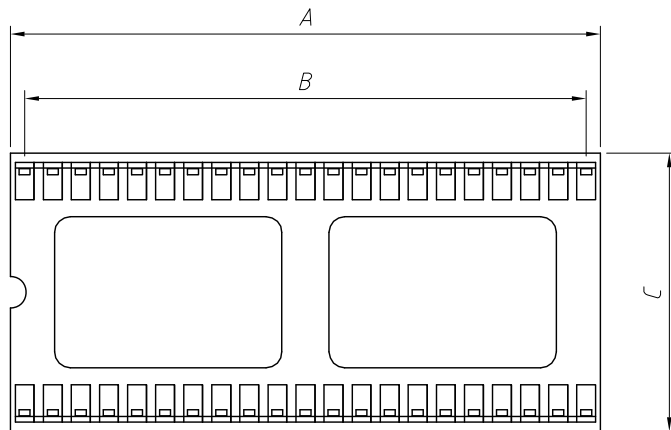

| Position | A     | B     | C     | D     |
|----------|-------|-------|-------|-------|
| 24       | 21.30 | 19.56 | 12.65 | 10.16 |
| 28       | 25.17 | 23.11 | 12.65 | 10.16 |
| 30       | 26.60 | 24.89 | 12.65 | 10.16 |
| 40       | 35.84 | 33.78 | 17.73 | 15.24 |
| 42       | 37.46 | 35.56 | 17.73 | 15.24 |
| 48       | 42.79 | 40.89 | 17.73 | 15.24 |
| 52       | 46.35 | 44.45 | 17.73 | 15.24 |
| 56       | 49.91 | 48.01 | 17.73 | 15.24 |
| 64       | 57.04 | 55.12 | 21.54 | 19.05 |

Order Information:

L-KLS1-216B-XX-1

L: RoHS  
IC Socket  
XX-No. of 16 ~ 64pin  
D Size: 1=10.16mm  
2=15.24mm 3=19.05mm

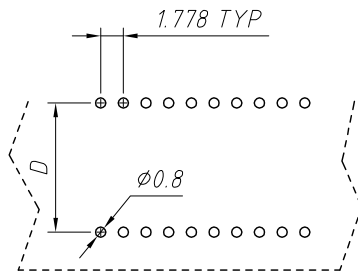

PCB Layout

| GENERAL TOLERANCE | PROJECTION |            | Description:                                       |
|-------------------|------------|------------|--|
| X. ±0.50          | UNITS      | mm         | 1.778mm Pitch IC Socket<br>Connector With Dip Type |
| .X ±0.25          | SCALE      | 1:1        |  |
| .XX ±0.10         | Draw by:   | Jenny      | KLS P/N: L-KLS1-216B-XX-1                          |
| ANGLE TOLERANCE   | Check by:  |            | NingBo KLS ELECTRONIC CO.,L TD.                    |
| X. ±5°            | Date       | 2018-03-01 |  |
| .X ±3°<br>.XX ±2° | SHEET      | 1 OF 1     |  |